

DBS722-CN Sounder base Product manual

Overview

The sounder base DBS722-CN serves to provide an acoustic alarm in an addressed fire detection system. Eleven tone types are programmed in the sounder base. Two activation levels can be configured.

Characteristic

- Power supply through the detection loop, no external 24VDC required
- Communication with the control panel via the detector loop when detector is being used
- Supports on-site programming, including configuration for sounder activation
- Compatible with automatic fire detectors OH720-CN, OP720-CN, HI720-CN
- Synchronization of sounds with all sounder bases on the same detector line
- Sound output ≥ 85 dB
- Ultra-low power consumption, energy efficient and environmentally friendly
- Enlarged cable entry holes for easy wiring
- Made of environmentally friendly and safe materials

Structure

The DBS722-CN sounder base consists of two parts, the standard detector base (1) and the sounder base (2).

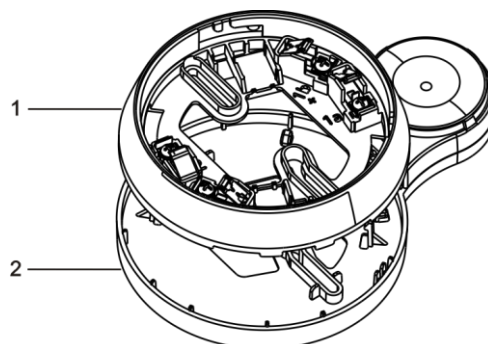

Installation

The sounder base is directly mounted on the ceiling. The cable entry is equivalent to that on a standard detector base.

1. Insert the cables.
2. Refer to Fig.1/Fig. 2. Fix the sounder base on the ceiling with two screws (distance is min. 40/max. 90mm). Make sure that no cable is crammed.

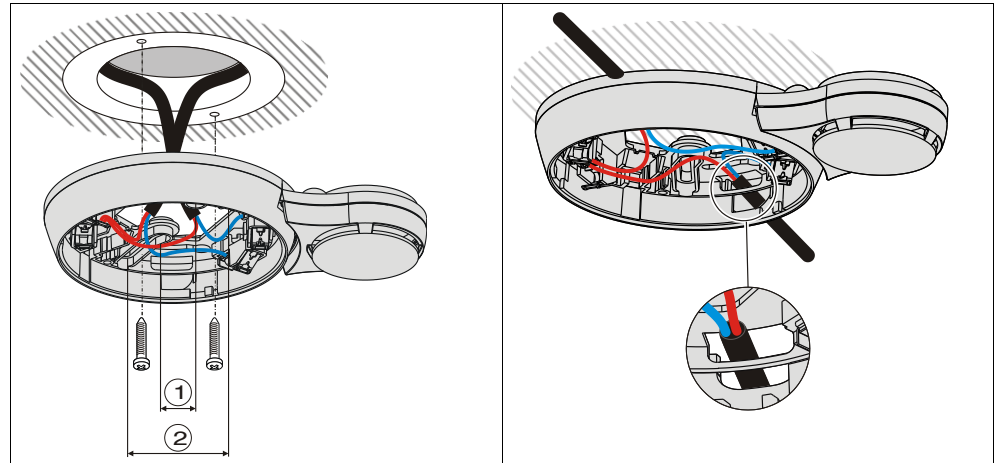

Fig. 1

Fig. 2

①	Minimum Ø 40 mm	②	Maximum Ø 90 mm
---	-----------------	---	-----------------

When the sounder base is separated from the standard detector base, do the following to reassemble:

1. Align the mounting holes of the standard detector base with the mounting holes of the sounder base (Fig. 3).
2. Push the standard base into the sounder base until the two locking fixtures secure it firmly in place (Fig. 4).

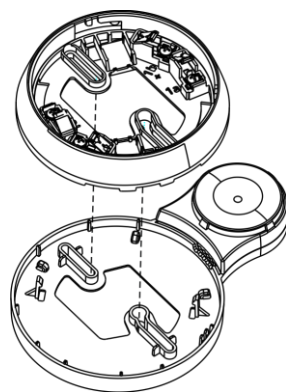

Fig. 3

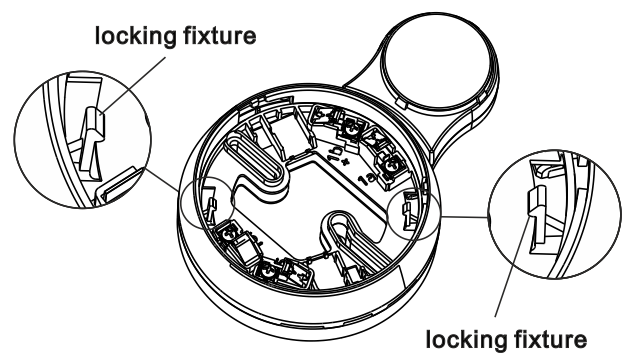

Fig. 4

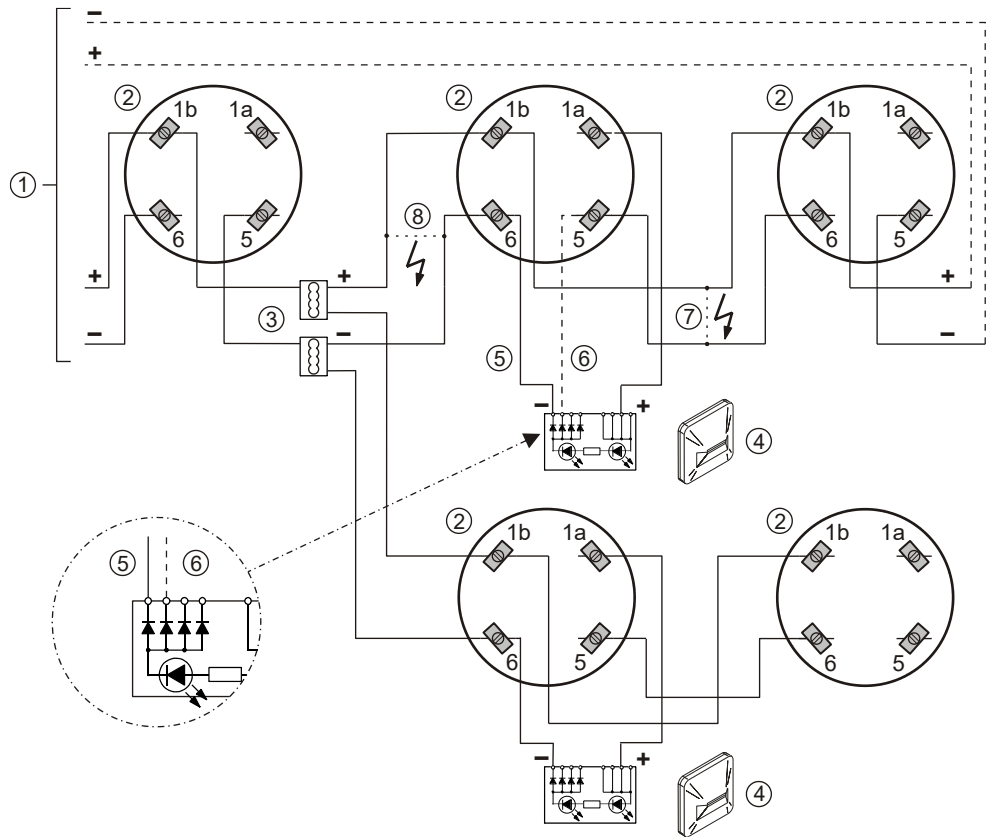

Fig. 5

Legend

- | | |
|------------------------------|---------------------------|
| 1 Control panel | 5 Cable -E_AI6 |
| 2 Sounder base DBS722-CN | 6 Cable -E_AI5 (Optional) |
| 3 Wiring terminal DBZ1190-XX | 7 Short circuit (error) |
| 4 Ext. alarm indicator | 8 Short Circuit (error) |

Notes

- If a shielded cable is used for connecting the external alarm indicator, its shield must be connected to the shield for the detector bus.
- The alarm indicator connected will continue to function normally in the event of a short circuit occurring at position 7 on the connection diagram. The alarm indicator is triggered by cable -E_AI6.

If the short circuit occurs at position 8 on the connection diagram, the alarm indicator will no longer be triggered.

As an option, the alarm indicator may also be connected using cable -E_AI5 connection. In this case, the alarm indicator will correctly indicate an alarm even if a short circuit occurs at position 8. Therefore, this ensures that the alarm indicator will always function correctly, regardless of a short circuit in position 7 or position 8.



The option described is possible in loop lines and stub lines.

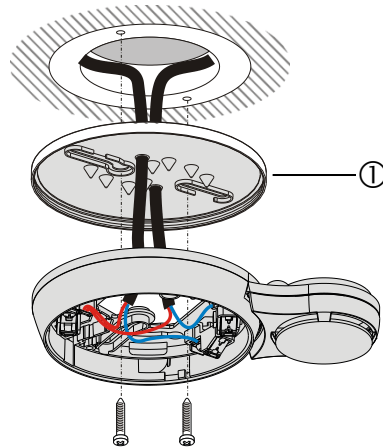

Fig. 6
1- Detector base seal RS720

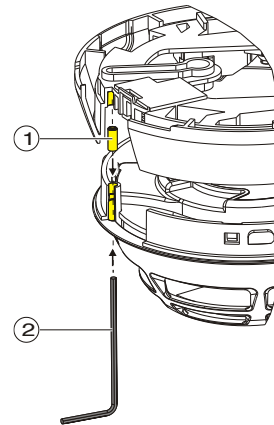

Fig. 7
1- Grub screw M3 x 12 mm
2- Hexagonal wrench

- **Detector base seal RS720 (Fig. 6)**

- The detector base seal RS720 is used for the installation of detectors in wet rooms. Protection type: IP42
- Compatible with sounder base DBS722-CN
- May only be used with recess-mounted cable feeds.
- The detector base seal is installed between the ceiling and the sounder base DBS722-CN.

- **Detector locking device LP720 (Fig. 7)**

- The detector can be protected against theft with the detector locking device LP720.
- The detector locking device LP720 is compatible with the sounder base DBS722-CN.
- Installation
 1. Insert the detector in the detector base.

Insert the hexagonal wrench provided in the bore hole on the detector housing and tighten the grub screw (Fig.7).

Dimensions

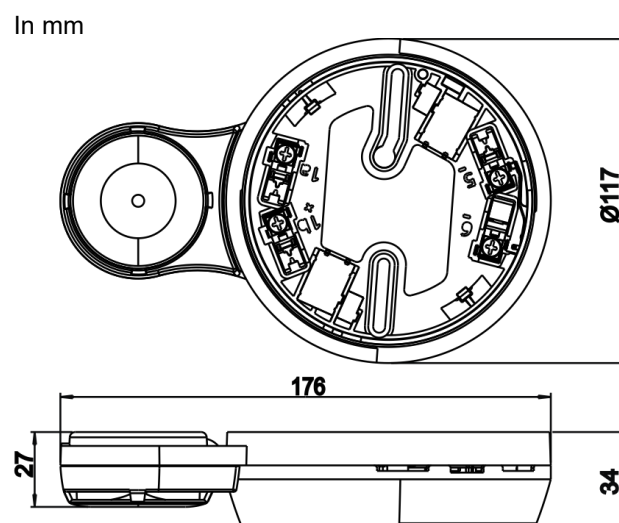

Specifications

Operating voltage	12.... 33 VDC
Operating current (quiescent)	180 μ A
Active current	1.2 mA
Tone types	11
Activation level	2
Sound intensity level	Soprano/Midrange
Operating temperature	-10... +50 °C
Storage temperature	-30... +70 °C
Humidity	\leq 95 % rel.
Communication protocol	C-NET
Connection terminals	0.2.... 1.5 mm ²
Color	White, RAL 9010

Ordering Information

Type	Material no.	Designation	Weight
DBS722-CN	S54319-F5-A101	Sounder base	0.115 kg
RS720	S54319-F8-A1	Detector base seal	
LP720	S54319-F9-A1	Detector locking device	
DBZ1190-AA		Micro terminals 0.28 ... 0.5 mm ²	
DBZ1190-AB		Connection terminals 1.0 ... 2.5 mm ²	