

SIEMENS

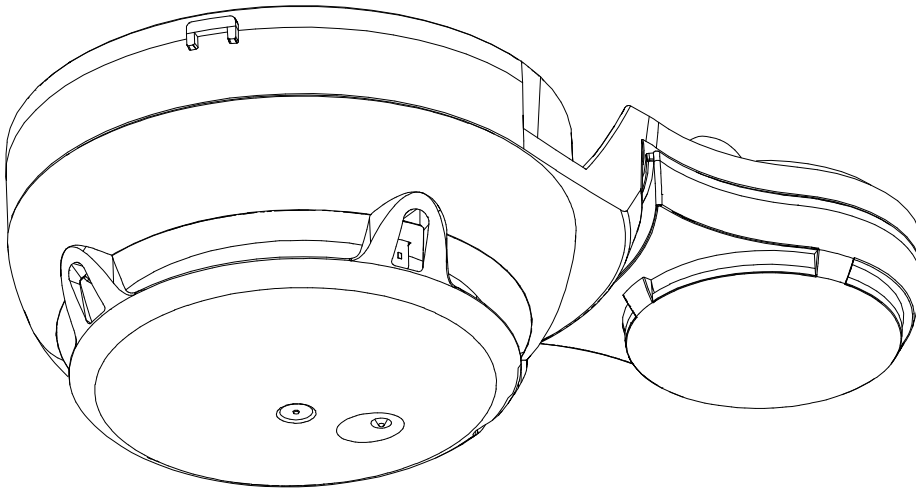

FDOOTS271

Radio fire detector with sounder

Mounting

Imprint

Technical specifications and availability subject to change without notice.

Transmittal, reproduction, dissemination and/or editing of this document as well as utilization of its contents and communication thereof to others without express authorization are prohibited. Offenders will be held liable for payment of damages. All rights created by patent grant or registration of a utility model or design patent are reserved.

Issued by:
Siemens Switzerland Ltd.
Smart Infrastructure
Global Headquarters
Theilerstrasse 1a
CH-6300 Zug
Tel. +41 58 724-2424
www.siemens.com/buildingtechnologies

Edition: 2025-09-19
Document ID: A6V14786091_en--_a

© Siemens 2025

Table of contents

1	About this document	5
1.1	Intended use.....	5
1.2	Applicable documents	5
1.3	Technical terms and abbreviations.....	6
1.4	Revision history	6
2	Mounting / Installation	7
2.1	Dimensions.....	7
2.2	Required space	7
2.3	Detector base FDB271	8
2.3.1	Detector base seal RS720	9
2.4	Mounting the FDOOTS271.....	10
2.5	Detector locking device FDBZ293.....	11
2.6	Designation plate FDBZ291	12
2.7	Detector dust cap FDZ291	13
2.8	Establishing factory settings.....	14

1 About this document

Source language and reference document

- The source/original language of this document is German (de).
- The reference version of this document is the international version in English. The international version is not localized.

Document identification

The document ID is structured as follows:

ID code	Examples
ID_languageCOUNTRY_modification index -- = multilingual or international	A6V10215123_deDE_a A6V10215123_en--_a A6V10315123_----_a

Intention and purpose

This document contains the entire information on the radio fire detector with sounder FDOOTS271. Follow the instructions consistently and carefully. This will ensure smooth and safe operation.

1.1 Intended use

The radio fire detector with sounder FDOOTS271 may only be used in a detector base FDB271 and together with a radio gateway FDCW241 in a fire detection system FS20/FS720/FC360.

The radio fire detector with sounder FDOOTS271 may only be used in a detector base FDB271 and together with a radio gateway certified by the manufacturer in a fire detection system.

1.2 Applicable documents

Document ID	Title
001508	Guidelines Connection factors, line resistances and capacitances for fire detection systems collective, AnalogPLUS, interactive, FDnet
008331	List of compatibility (for 'Sinteso™' product line)
009409	Data sheet Colored detectors, bases and base attachment FDO., FDOOT..., FDT..., FDB..., FDCW241
A6V10208552	Installation Detector locking device FDBZ293
A6V10227631	Planning Radio fire detection system SWING
A6V10227639	Technical manual Radio gateway FDCW241
A6V10227643	User Guide SWING-Tool FXS2061
A6V10229261	List of compatibility (for 'Cerberus™ PRO' product line)
A6V10254740	Operating instructions Solo461 heat detector tester kit RE7T
A6V10271323	Data sheet SWING Radio fire detection system
A6V10367669	Open-Source Software (OSS) Licenses SWING
A6V10882301	List of compatibility (for 'FC360' product line)
A6V16292987	Technical manual Radio fire detector with sounder FDOOTS271

1.3 Technical terms and abbreviations

Term	Explanation
ASApplus (ASApplus technology™)	Advanced Signal Analysis
Battery empty	Fault message in the event of a total failure of the battery
Battery low	Fault message with reserve battery activated
FDnet/C-NET	Addressed detector circuit
IAI	Internal indicator (indicates operating condition, e.g., alarm)
LED	Light-emitting diode

1.4 Revision history

The version of the reference document is valid for all languages into which the reference document is translated.



The first edition of the document into a language and/or for a country might have the version 'd', for example, instead of 'a', if the document has already reached this publication version.

The table below shows the revision history of this document:

Version	Edition date	Brief description
a	2025-09-19	First edition

2 Mounting / Installation

2.1 Dimensions

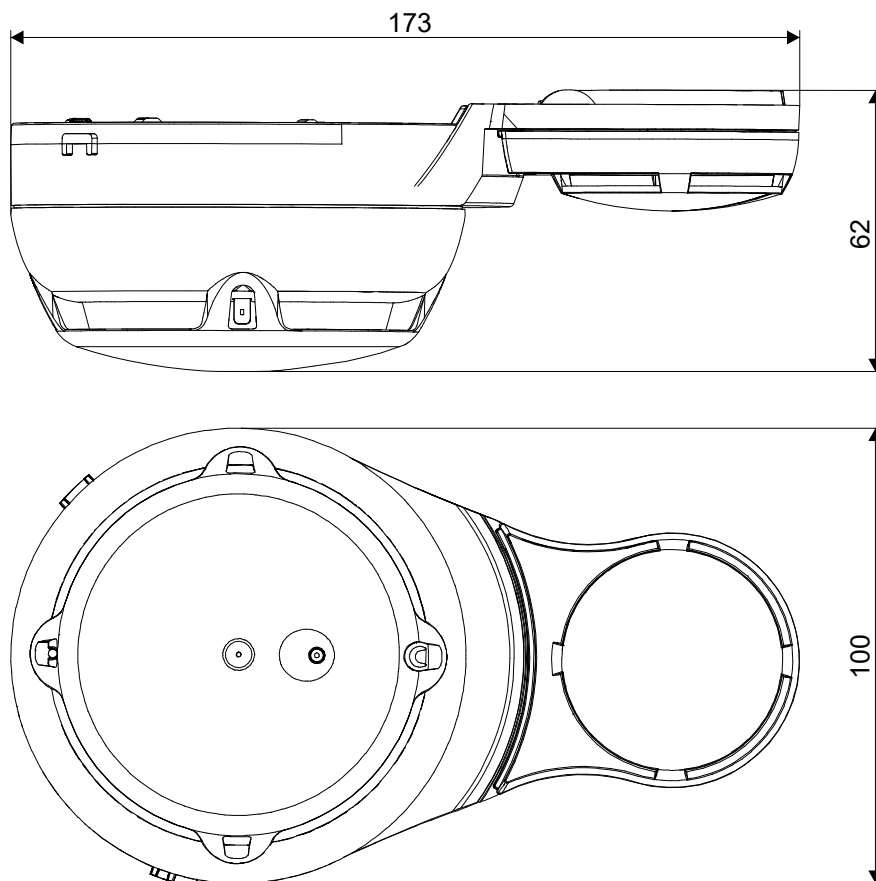

2.2 Required space

- Upon insertion of the detector, the detector base is stressed by compression, tension and torsion. The fixing must thus be designed accordingly.
- Detector bases must be placed flat on the ceiling.
- Avoid mounting on steps, concrete ribs, etc.
- When selecting the installation position, take into account any structures that may impair radio reception.
- The radio detector/sounder must have a free space of at least 50 cm at the bottom and of at least 2 cm (x) at the side to be able to remove the radio detector/sounder using the detector exchanger.
- There must be a free space of at least 8.5 cm (y) at the sounder side, measured from the edge of the detector base.
- Warped detector bases will make it difficult or impossible to insert the detectors using the detector exchanger.

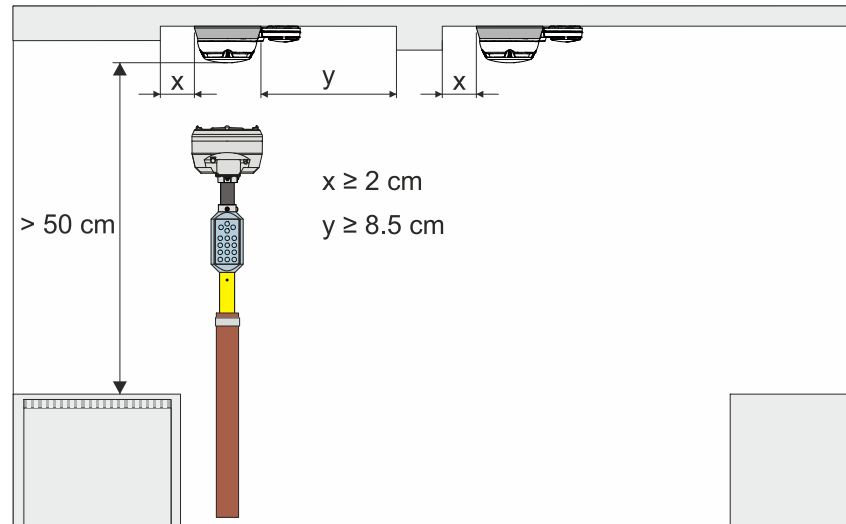

Fig. 1: Minimum distances when mounting detector bases

2.3 Detector base FDB271

The detector base (1) must be connected safely to the ceiling.
Use two screws (2) to screw the detector base to the ceiling.

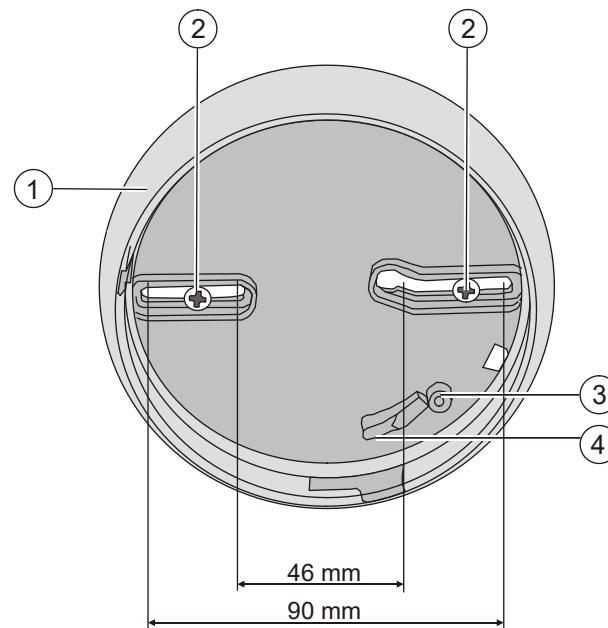

Fig. 2: Mounting of detector base

- 1 Detector base
- 2 Screws, max. $\text{Ø} 4 \text{ mm}$
- 3 Holder for detector locking device
- 4 Cam

2.3.1 Detector base seal RS720

Use the detector base seal for mounting the radio detector/sounder in wet rooms (protection category IP33).

The detector base seal is not compatible with the designation plate FDBZ291.

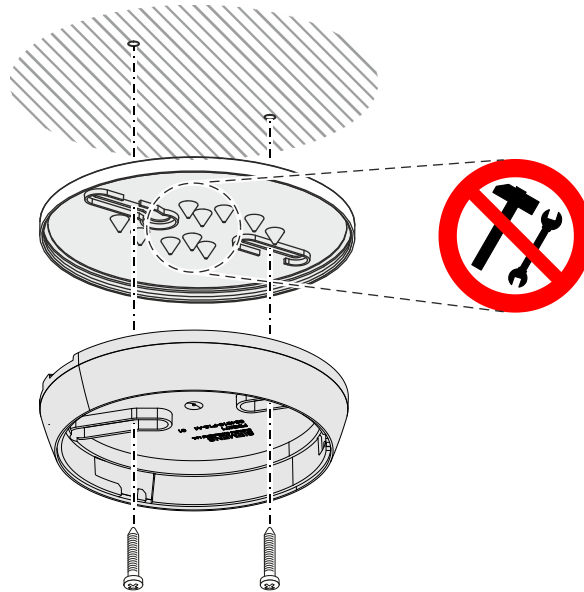

Fig. 3: Mounting the detector base seal RS720

1. **NOTICE! Excessively large openings in the detector base seal will reduce the protection category (IP33).** Do not cut or drill any openings into the detector base seal.
2. Mount the detector base seal between the ceiling and the detector base FDB271.

2.4 Mounting the FDOOTS271

Inserting it into the detector base activates the radio detector/sounder FDOOTS271 and it then logs on to other radio devices immediately. Therefore, start at the radio gateway and work outwards to mount the individual FDOOTS271.

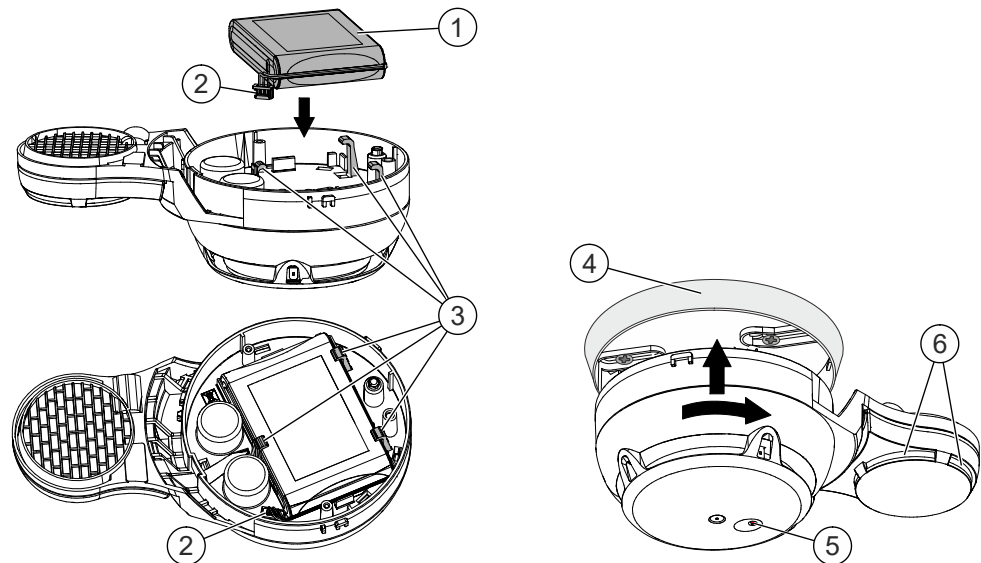

Fig. 4: Mounting the FDOOTS271

- 1 Battery pack BAT3.6-10 (not within the scope of delivery)
- 2 Battery connector
- 3 Holder
- 4 Detector base FDB271
- 5 Internal indicator
- 6 Water drainage



For the flashing behavior of the internal indicator, see 'Internal indicator'.

- ▷ The radio gateway has been activated and switched to maintenance mode.
 - ▷ The FDOOTS271 has the factory setting (see 'Establishing factory settings [→ 14]').
 - ▷ You have the battery pack and the required accessories at hand.
 - ▷ The FDB271 detector base is mounted (see 'Detector base FDB271 [→ 8]').
1. Mount the desired accessory.
 2. Label the new battery pack (1) with the current date.
 3. Plug in the battery connector (2).
 - ⇒ The internal indicator (5) lights up red for 5 seconds.
 - ⇒ The internal indicator flashes after another 10 seconds: This means the FDOOTS271 is not mounted on the detector base.
Red = Factory setting
Green = The FDOOTS271 was already logged on to a radio gateway.
 - ⇒ If that is not the case, the battery pack is defective and must not be used.
 4. Insert the battery pack.
 - Pay attention to the position of the battery cable.

- The battery pack must lock in place at the holders (3).
- 5. Insert the FDOOTS271 into the detector base.
 - ⇒ The internal indicator flashes green: The FDOOTS271 logs onto the radio gateway.
 - ⇒ The internal indicator does not flash any more: Successful logging on to the radio gateway.
- ⇒ The FDOOTS271 has been mounted and prepared for commissioning.

2.5 Detector locking device FDBZ293

The detector locking device FDBZ293 can be fitted to protect the radio detector/sounder against theft.

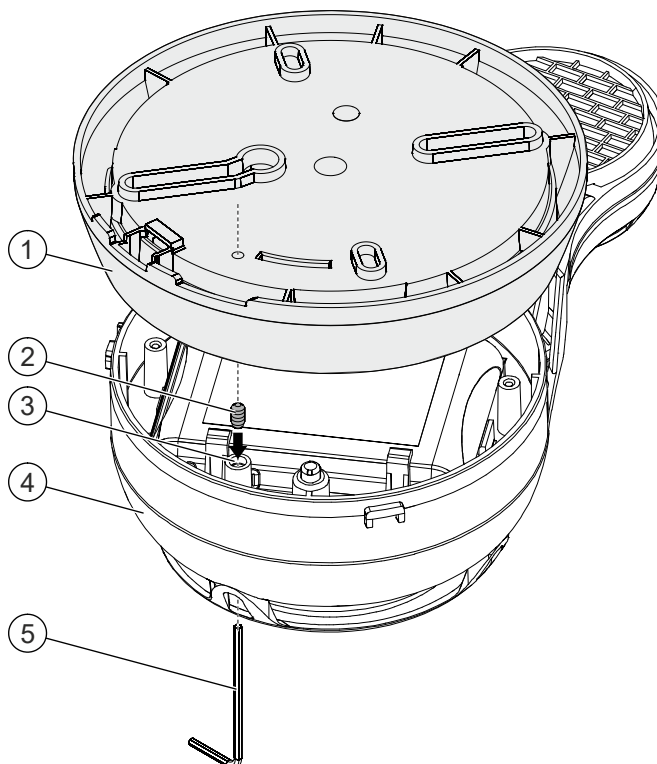

Fig. 5: Mounting the detector locking device FDBZ293

1. Insert the grub screw with hexagon socket (2) into the hole (3) on the radio detector/sounder (4).
 2. Insert the radio detector/sounder into the detector base (1).
 3. Use an Allen key (5) to tighten the grub screw through the hole (3) in the detector base.
- ⇒ The radio detector/sounder can no longer be removed from the detector base without using a tool.

2.6 Designation plate FDBZ291

Use designation plate FDBZ291 to designate the radio detector/sounder with a site address.

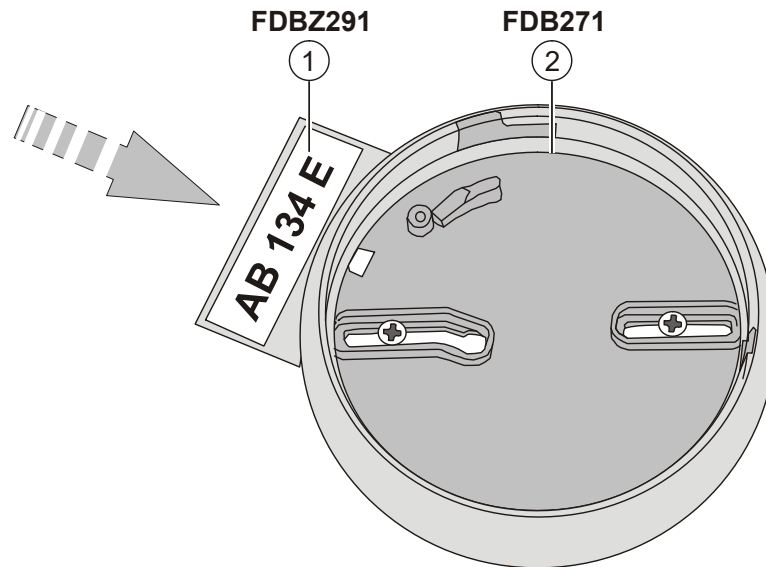

Fig. 6: Mounting the designation plate

1. Label the designation plate (1) with the site address.
2. Push the designation plate at the side into the detector base (2).

2.7 Detector dust cap FDZ291

During the construction phase, you can cover the radio detector/sounder with a detector dust cap FDZ291 for protection against dust and dirt.

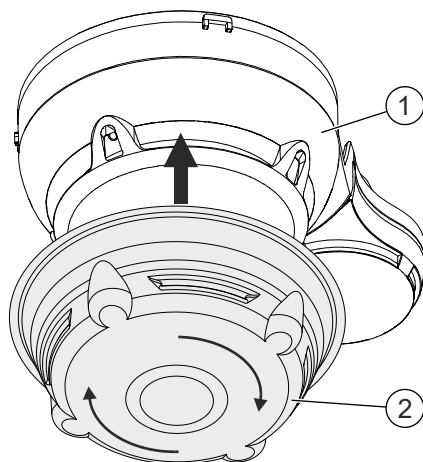

Fig. 7: Mounting/removing the detector dust cap

Insert and remove the detector dust cap (2) manually or using the detector exchanger, e.g., FDUD291.

1. Mounting: Press the detector dust cap (2) onto the radio detector/sounder (1).
2. Removal: Remove the detector dust cap clockwise (arrowed direction).

2.8 Establishing factory settings

All existing settings are deleted and the factory setting is applied.

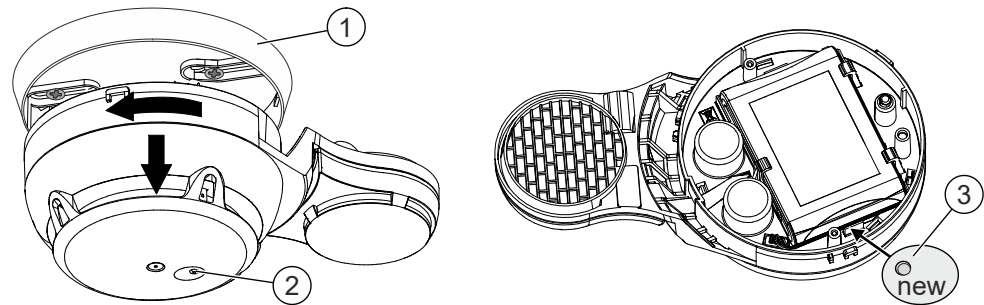

Fig. 8: Establishing the factory setting

- ▷ The radio detector/sounder is supplied with power.
- ▷ There is a thin pin.
- 1. Remove the radio detector/sounder from the detector base (1).
- 2. Wait until the internal indicator (2) flashes green, every 2 seconds.
 - ⇒ The radio detector/sounder is 'out of base'.
- 3. Lift the battery pack to access the 'new' opening (3).
 - The battery connector must remain plugged in.
- 4. Press the thin pin into the 'new' opening for 5 seconds.
 - ⇒ The internal indicator flashes red, every 2 seconds.
 - ⇒ The radio detector/sounder has the factory setting.

Issued by
Siemens Switzerland Ltd
Smart Infrastructure
Global Headquarters
Theilerstrasse 1a
CH-6300 Zug
+41 58 724 2424
www.siemens.com/buildingtechnologies

© Siemens 2025

Technical specifications and availability subject to change without notice.