

## QAE22.2

### Immersion Temperature Sensor



<b>Description</b>	Immersion sensor for measuring water temperature in pipes and tanks.
<b>Application</b>	Water temperature measurement for the following: <ul style="list-style-type: none"> <li>• Controlling or limiting flow temperature.</li> <li>• Limiting return temperature.</li> <li>• Controlling domestic water temperature.</li> </ul>
<b>Product Number</b>	QAE22.2 Temperature sensor with a maximum immersion stem length of 5 inches (130 mm); includes a compression ferrule union with a threaded sleeve.

**Function** The sensor measures the medium temperature in the solar panel with its nickel element and communicates it to a controller. The resistance value of the element changes as a function of the temperature. It is delivered

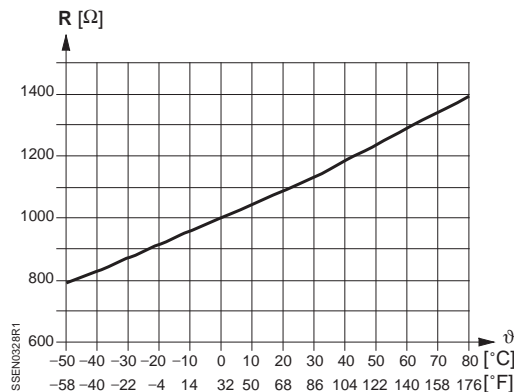

**Characteristic**

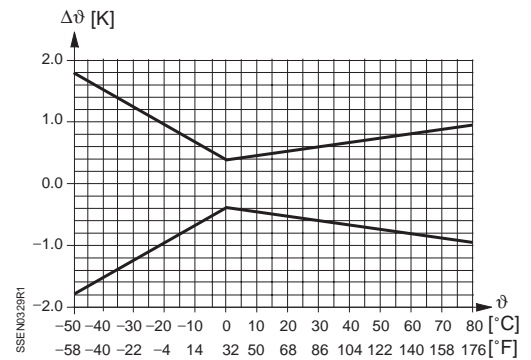

**Accuracy**

<b>Mechanical Design</b>	The sensor consists of the following components: <ul style="list-style-type: none"> <li>• Two-sectional plastic housing comprised of base with connection terminals and removable cover (snap-on design).</li> <li>• Immersion rod with LG-Ni 1000 sensing element.</li> <li>• Compression ferrule union with threaded sleeve.</li> </ul>
--------------------------	---

## Specifications

Measuring range	-22°F to 266°F (-30°C to 130°C)
Sensing element	LG-Ni Ni 1000 Ω at 32°F (0°C)
Time constant without well	Approximately eight seconds
Permissible ambient temperature	
Operation	
Temperature	23°F to 122°F (-5°C to 50°C)
Humidity	5 to 95% rh
Transportation	
Temperature	-13°F to 158°F (-25°C to 70°C)
Humidity	<95% rh
Electrical connections	Screw terminals (interchangeable)
Cable entry gland	Conduit connector (P/N 544-023)
Permissible cable length	See controller datasheet
Weight without well	0.39 lb. (0.178 kg)

## Installation

Depending on use, locate the sensor as follows:

- *For flow temperature control*
  - In the heating flow:
    - Directly after the pump, if the pump is mounted in the flow.
    - 5 to 6 feet (1.5 to 2 m) after the mixing valve, if the pump is mounted in the return.
- *For limitation of the return temperature*
  - In the return pipe where the sensor can correctly measure the temperature to be limited. The water must be well-mixed where the sensor is located.

The sensor should be installed in an elbow so that the well points into the direction of flow. The immersion length must be a minimum of 1.97 inches (50 mm).

Do not insulate the sensor.

Before mounting the sensor, a threaded fitting or T-piece must be welded in the pipe.

Mount so that the cable does not enter from the top.

Installation instructions are printed on the packaging.

## Mounting Positions

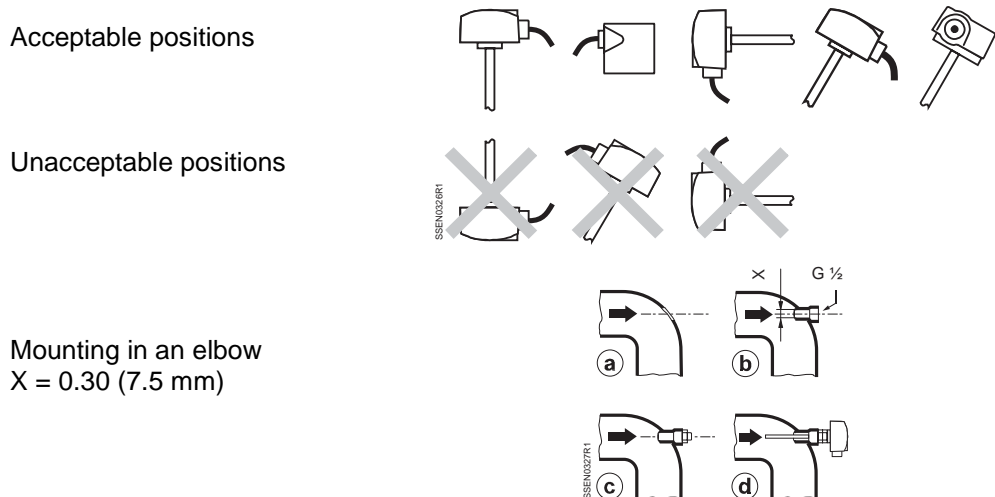

**Figure 1. Mounting Positions.**

**Dimensions**

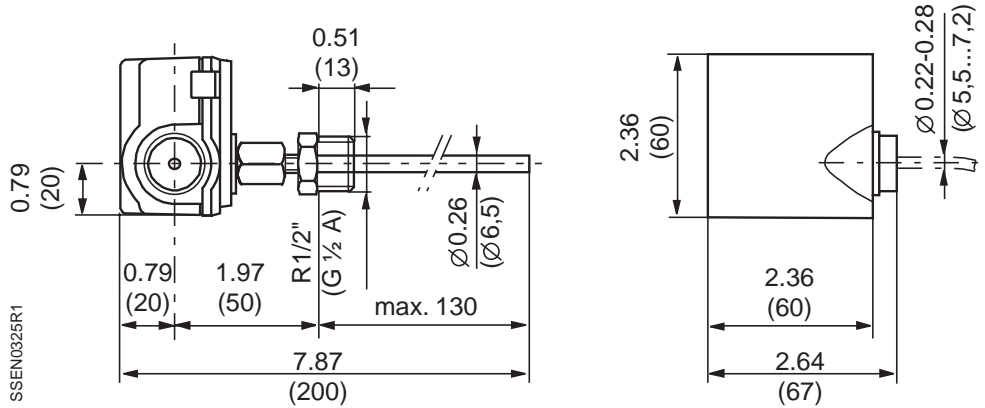

**Figure 2. Dimensions in Inches (Millimeters).**

Information in this publication is based on current specifications. The company reserves the right to make changes in specifications and models as design improvements are introduced. Other product or company names mentioned herein may be the trademarks of their respective owners.  
 © 2002 Siemens Building Technologies, Inc.